



PROTECH METAL ROOFING 
& CLADDING SYSTEM

We don't just **SUPPLY**
We **BUILD**





ABOUT US

Since its inception in 2016, ARKO BUILDING PRODUCTS PVT LTD has successfully executed over 100 steel building projects throughout India. The company is dedicated to prompt manufacturing, delivery, and service, with a strong emphasis on quality and precision in every project undertaken.

PROTECH is a prominent brand within the ARKO family that specializes in pre-engineered buildings. This brand provides comprehensive turnkey solutions, which include the design and manufacturing of all structural components in accordance with specified engineering drawings. This encompasses the production of roofing and cladding sheets as well as insulated panels, such as PUF roofs and walls. Additionally, PROTECH oversees the erection of pre-engineered building structures, along with the installation of roofing and cladding.

OUR POLICY STATEMENT

We at ARKO BUILDING PRODUCTS PVT LTD are committed to ensuring timely manufacturing, supply, and service delivery, while maintaining the highest standards of quality and precision.



PRODUCTS & SERVICES



PUF SANDWICH PANELS



ROOFING / CLADDING SYSTEMS



PRE-FABRICATED ROOMS



PRE-FABRICATED BUILDINGS



POLYCARBONATE MULTIWALL



PRE-ENGINEERED BUILDINGS



EXPERTS AND PROFESSIONALS



24/7 EMERGENCY AVAILABLE



FREE INSPECTION



SATISFACTION GAURANTEE

HI RIB ROOFING & CLADDING SYSTEMS



ARKO MAKE colour metal roofing is the most versatile roofing product in the market and offers you both elegance and flexible design for any building need. Long lengths and weatherproof side lap allow ARKO TECH to be used safely on roof pitches as low as 3 deg in single sheet lengths, 5 deg with end laps, and for vertical cladding. ARKO Hi-Rib is also available in crimp curved sections.

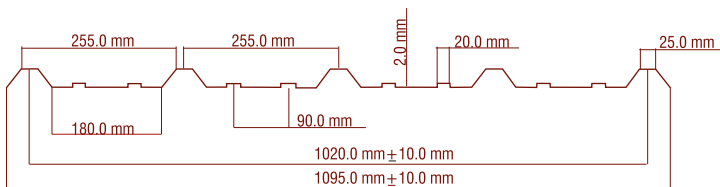

Pre-Painted GalvaZinc (Galvalume)

(55% Aluminium 44% Zinc Alloy 1.3% Silicon)

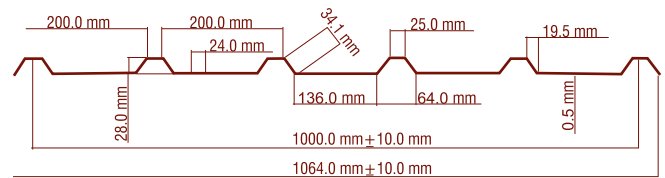

Pre-Painted Galvanized (Galvanized)

(120 GSM Galvanized Steel Sheet)

GalvaZinc Coating	— AZ 150 GSM
Primer Coat	— 5 microns epoxy / PU on both sides
Paint Coat	Regular Modified Polyester Silicon Modified Polyester & PVF 2
Paint Thick (top)	— 18-20 microns
Paint Thick (bottom)	— 8-10 microns
Surface Paint Reflection	— Semi Gloss/ Matt finish
Conforms to	— ASTM A792, A755, JIS G3321, 63322, AS 1397
Yield Strength	— 550 MPA

GalvaZinc Coating	— Z 120 GSM
Primer Coat	— 5 microns epoxy / PU on both sides
Paint Coat	— Regular Modified Polyester Silicon Modified Polyester & PVF 2
Paint Thick (top)	— 18-20 microns
Paint Thick (bottom)	— 5-7 microns
Surface Paint Reflection	— Semi Gloss/ Matt finish
Conforms to	— IS:277, IS:14246
Yield Strength	— 245/550 MPA

Max allowable support spacings

Type of Span	0.50 mm TCT steel (550 Mpa)	0.50 mm TCT steel (240 Mpa)
Roofs		
Single	900 mm	800 mm
Internal span	1800 mm	1400 mm
End span	1200 mm	1000 mm
Overhangs		
Without edge stiffening	150 mm	150 mm
With edge stiffening	300 mm	300 mm
Walls		
Single span	1500 mm	1100 mm
Internal span	2000 mm	1400 mm
End span	1800 mm	1200 mm
Overhangs	300 mm	300 mm

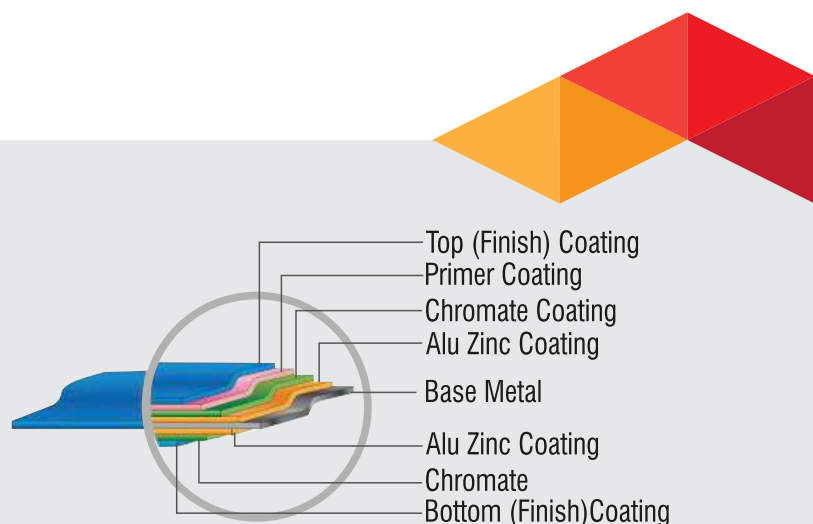

STANDING SEAM ROOFING SYSTEM

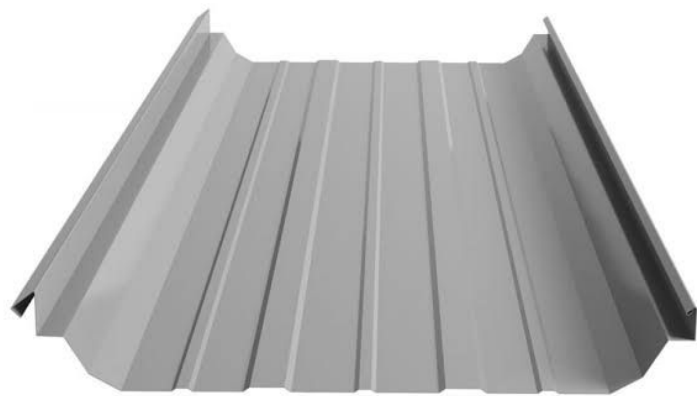

Standing seam roofing is a popular metal roofing system known for its durability, leak proof solution, sleek appearance, and weather resistance.

SPECIFICATIONS:

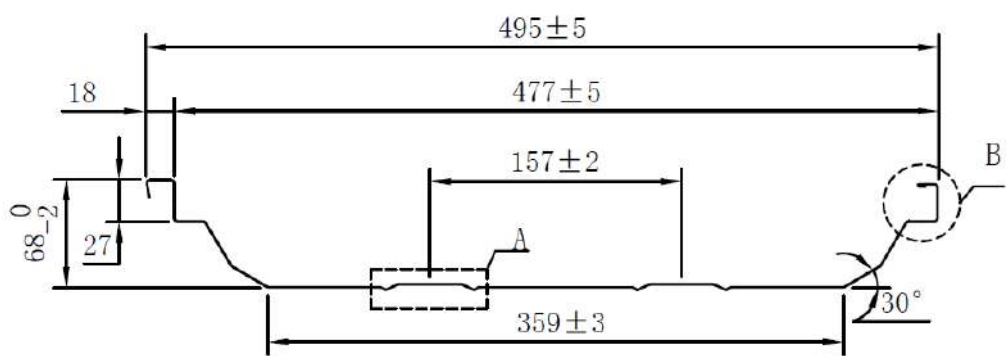

Material	—	Galvalume
Thickness	—	0.50 - 0.60 MM
GSM	—	AZ 150
GRADE	—	350 Mpa / 550 Mpa
Panel Width	—	475 and 495 mm
Panel Length	—	Customizable; often cut to fit the roof dimensions
Seam Height	—	68 MM ensuring secure interlocking
Coating	—	Paint: RMP, SMP, PVDF for superior fade and weather resistance Galvalume or galvanized coatings for added corrosion resistance
Fastening System	—	Concealed clips or fasteners, ensuring a clean look and minimal risk
Slope Requirements	—	Minimum slope: 1:12 (for some profiles) or 3:12 for better water

FEATURES

- ▲ **DURABILITY**
Lasts 20 – 30 years with minimal maintenance.
Resistant to wind, fire, and impact damage.

▲ **WEATHER RESISTANCE**
Raised seams prevent water infiltration, ideal for areas with heavy rainfall or snow.

▲ **AESTHETIC APPEAL**
Sleek, modern lines.
Available in a variety of colors and finishes.
- ▲ **ENERGY EFFICIENCY**
Reflects sunlight, reducing heat absorption.
Often qualifies as a “cool roof” under energy efficiency standards.

▲ **EASE OF INSTALLATION**
Nap-lock and mechanical seam options simplify installation.
Prefabricated panels save time.

▲ **ENVIRONMENTALLY FRIENDLY**
Made from recyclable materials.
100% recyclable at the end of its lifecycle.

BUBBLE INSULATION SHEET

Our Bubble Insulation provide excellent thermal insulation to Steel Buildings with additional features of waterproofing and acoustic insulation.

Our reflective insulation works on the principle of thermos. It prevents the heat from coming in the building during summers thus keeping the insides cool and prevents the heat from escaping the building during winters thereby keeping the building warm.



PRODUCT	R Value	Glass Wool
4mm	16.00 BTU* In/(hr OF ft2)	75mm x 24kg/m3
6mm	16.50 BTU* In/(hr OF ft2)	100mm x 24kg/m3
8mm	17.50 BTU* In/(hr OF ft2)	100mm x 24kg/m3
10mm	18.50 BTU* In/(hr OF ft2)	125mm x 24kg/m3
12mm	22.50 BTU* In/(hr OF ft2)	125mm x 24kg/m3
20mm	24.00 BTU* In/(hr OF ft2)	150mm x 24kg/m3

KEY FEATURES



HEAT INSULATION



ACOUSTIC INSULATION



MAINTENANCE FREE



SAVES COST



HIGH R VALUE



FIRE RETARDANT



NON HAZARDOUS



EASY INSTALLATION

SKYLIGHT

POLYCARBONATE

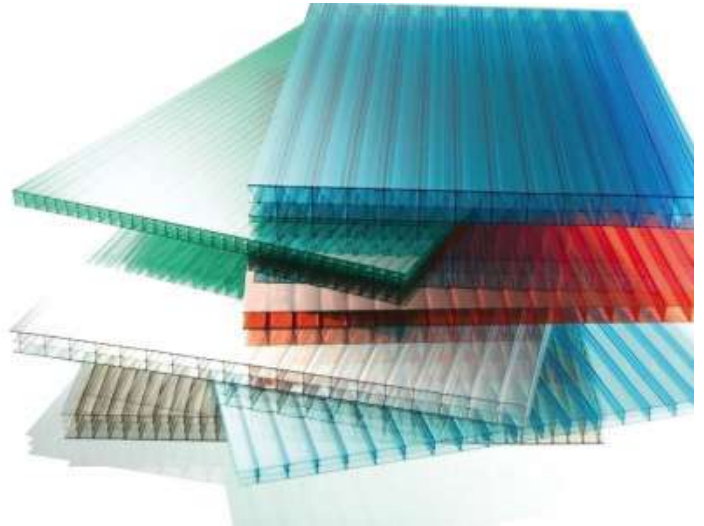
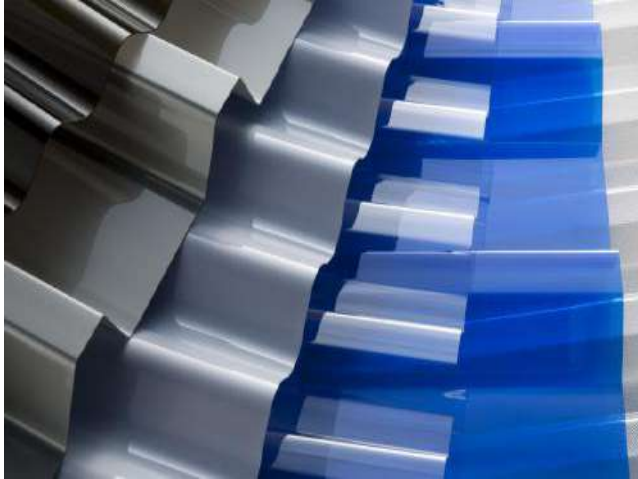

1. Compact Clear / Light Diffuser / Embossed Polycarbonate / Diamond

Profile	— Plain or As require profile model
Material	— 100% Bayer/Sabic Polycarbonate Resin
Thickness	— 0.80 mm To 12 mm
Length	— Customizable Available
Width	— 4, 5, 6, 7 feet
Colour	— Clear, Opal White, Green, Lake Blue, Blue, Bronze, Embossed
Accessories	— SDS Screws & Silicon Sealant
Protection	— UV Coated

2. Multiwall

Profile	— Plain twin wall / X-PROFILE
Material	— 100% Bayer/Sabic Polycarbonate Resin
Thickness	— 4 mm To 18 mm
Length	— 39 feet & Customizable Available
Width	— 4, 7 feet
Colour	— Clear, Opal White, Green, Lake Blue, Blue, Bronze
Accessories	— Aluminium Channel With Gasket and SDS Screws & Silicon Sealant
Protection	— UV Coated

3. Honeycomb Panel



Profile	— 100% leak proof
Material	— 100% Bayer/Sabic Polycarbonate Resin
Thickness	— 12 mm
Protection	— UV Coated
Scratch Protection	— Guard Film
Length	— Customizable Available
Width	— 7 feet
Colour	— Clear, ICE, Green, Blue, Bronze
Accessories	— Aluminium Channel, U & C Section, and SDS Screws & Silicon Sealant

KEY FEATURES

- | | | | |
|--|---|---|--|
|  | UPTO 70% ENERGY SAVING ARKO SKYLIGHT |  | EXCELLENT LIGHT TRANSMISSION UPTO 88% (10MM) |
|  | UV PROTECTION: CO-EXTRUDED 1 SIDE & 2 SIDES |  | TEMPERATURE RESISTANT: B/W -40°C +130°C |
|  | LIMITED 10 YEAR WARRANTY |  | HIGH LOAD PERFORMANCE WITH LOW WEIGHT |

DECK SHEETS

Composite Floor Deck is a steel deck with a ribbed profile, which binds with concrete slab and together forms a part of the floor structure. This interlocking between the concrete and the floor deck is brought about through a system of embossment and ribs which are built into the deck, creating a reinforced concrete slab that serves the dual purpose of permanent form and positive reinforcement. Composite decking is one of the most effective method of constructing floors in steel building and very useful in high rise RCC / Steel Buildings. Metal decking can be effectively used in Multi-storey buildings Industrial/ Residential), Shopping malls, Super markets, SEZs, Silos, Storage facilities, mezzanines, bridges, walkways, platforms, etc.

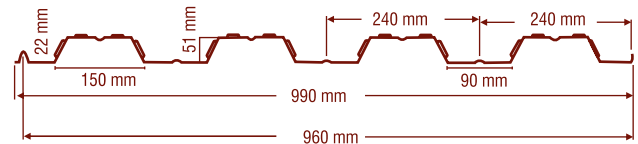

51/240

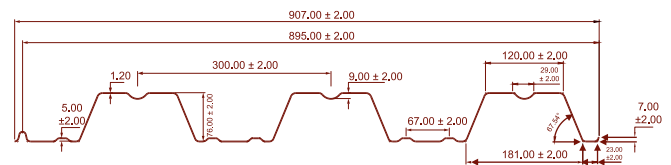

76/305

METAL DECKING

- Profile** — 44 / 130 (44 mm depth x 960 mm width)
51 / 240 (51 mm depth x 990 mm width)
76 / 305 (76 mm depth x 915 mm width)
- Material** — CR Steel as per IS:513 /
HR Steel as per IS:1079 /
Galvanized Steel (as per IS:277)
- Thickness** — 0.70 to 2.0mm
- Length** — 12000 mm (12 MTR)
- Type** — Bare, Primer coated, Galvanized

We supply suitable size of decking with optional features as per customer's specifications / drawings, for easy erection and also to avoid any wastage / rework at site.

Thickness & Weight

Total Coated Thickness	Base Metal Thickness	Weight of Profile Kg/m ²
------------------------	----------------------	-------------------------------------

0.70	0.67	6.85
0.80	0.77	7.86
0.90	0.87	8.89
1.00	0.97	9.99
1.20	1.17	11.99
1.50	1.47	14.80

Allowable Loads in kg/m² for 245 Mpa Yield Strength of Material *

Steel Grade 250Mpa THICKNESS (mm)	Span (m) Results are Maximum Load (kg/m2) SPAN IN METERS												
	1.0	1.10	1.20	1.30	1.40	1.50	1.60	1.70	1.80	1.90	2.00	2.20	2.50
0.7	740	672	615	572	525	492	460	435	392	-	-	-	-
0.8	952	865	792	732	680	632	595	545	485	430	390	-	-
0.9	1190	1080	992	915	850	792	742	660	588	525	470	390	-
1.0	1450	1320	1210	1115	1035	968	880	780	695	620	560	460	-
1.2	2035	1852	1700	1565	1452	1328	1165	1035	920	820	740	610	450
1.5	2650	2500	2300	2015	1902	1778	1615	1455	1320	-	-	-	-

GI & HR

PURLINS

Z and C purlins are specially designed to provide economy to building construction and keep the site clean and environmental friendly and it is a strong and sturdy to hold the building in position for lifelong. Z and C section are accurately roll formed from high strength galvanised steel, Arko give cut to the length section with pre punched hole as per your drawing and required dimensions to provide speed and faster construction.

STRUCTURE

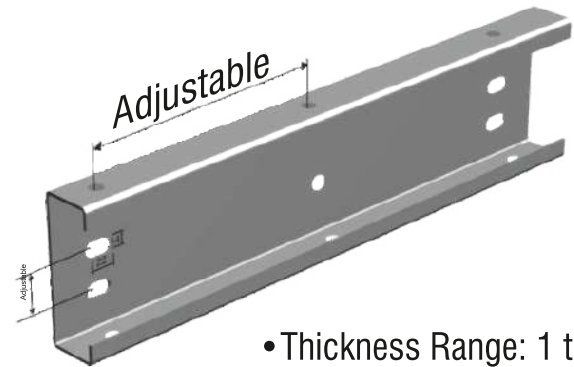

- Thickness Range: 1 to 3 mm
- Customized size of purlin also available

Purlin-C

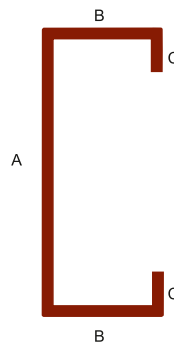

PROTECH Purlin 'C' Shape

SIZE	A	a	C
100	100	50	15
150	150	60	15
175	175	60	18
200	200	70	20
220	220	80	20
250	250	70	20
300	300	80	20

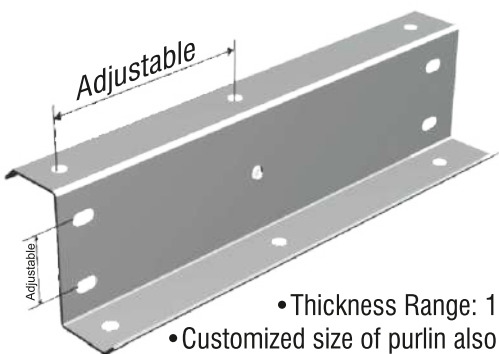

- Thickness Range: 1 to 3 mm
- Customized size of purlin also available

Purlin-Z

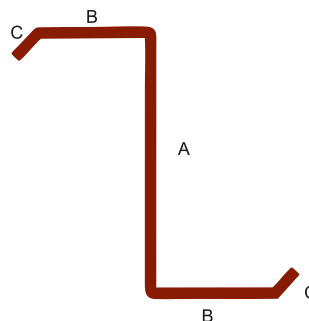

PROTECH Purlin 'Z' Shape

SIZE	A	B	C
100	100	50	15
150	150	60	15
175	175	60	18
200	200	70	20
220	220	80	20
250	250	70	20
300	300	80	20

KEY FEATURES OF PURLIN

1. WEIGHT AND COST EFFICIENCY
2. VERSATILITY AND FLEXIBILITY
3. ENHANCED LOAD-BEARING CAPACITY
4. ADAPTABILITY FOR ROOFING SYSTEMS
5. REDUCING THERMAL BRIDGING
6. DESIGN FLEXIBILITY
7. STRUCTURAL INTEGRITY
8. MAINTENANCE AND LONGEVITY LOW

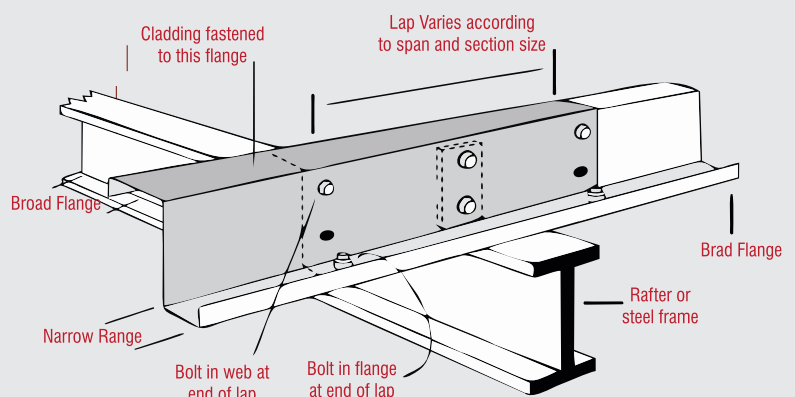

PP - S.S. TURBO

MATERIAL OF CONSTRUCTION (M.O.C.)

SIZE (THROAT DIA)	MODEL	NO. OF FINS	FINS	TOP COVER	BOTTOM RING	FASTENERS	INTERNAL	BEARINGS
21" 560 mm	PPSS 22	24	0.35 mm S.S. 430	0.50 mm S.S.430	Polypropylene (PP)	G.I.	Shaft- G.I. Other Fittings - PP	HCH make or equivalent
24" 610 mm	PPSS 24	39	0.35 mm S.S. 430	0.50 mm S.S.430	Polypropylene (PP)	G.I.	Shaft G.I. Other Fittings - PP	HCH make or equivalent



VENTILATOR FANS ALLUMINIUM TURBO

MATERIAL OF CONSTRUCTION (M.O.C.)

SIZE (THROAT DIA)	MODEL	NO. OF FINS	FINS (BLADES)	TOP COVER	BOTTOM RING (NECK)	RIVETS/ FASTENERS	INTERNAL FITTINGS	BEARINGS	NET WT.
24" (600 MM)	AL-24	42	0.50 MM ALL	1.20 MM AL or 0.50 MM S.S.304	1.20 MM AL. or 0.50 MM S.S.304	AL/S.S or equivalent	S.S or equivalent	SKF make or equivalent	4.40 KILOS
21" (530 MM)	AL-21	36	0.50 MM ALL	1.20 MM AL or 0.50 MM S.S.304	1.20 MM AL. or 0.50 MM S.S.304	AL/S.S or equivalent	S.S or equivalent	SKF maket or equivalent	4.00 KILOS

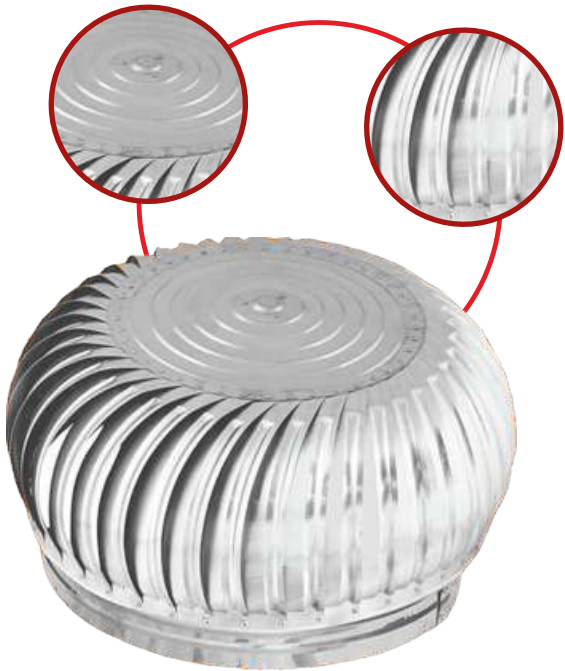

STAINLESS STEEL TURBO

MATERIAL OF CONSTRUCTION (M.O.C.)

SIZE (THROAT DIA)	MODEL	NO. OF FINS	FINS	TOP COVER	BOTTOM RING	RIVETS/ FASTENERS	INTERNAL FITTINGS	BEARINGS	NET WT.
600 mm (24")	SS-24	42	0.35 mm S.S.304 /430	1.20 mm AL. or 0.50 mm S.S.304 /S.S.430	1.20 mm AL. or 0.50 mm S.S.304	AL/S.S.	S.S.	SKF make or equivalent	5.80 kg
530 mm (21")	SS-21	36	0.35 mm S.S.304	1.20 mm AL or 0.50 mm S.S.304 /S.S.430	1.20 mm AL. or 0.50 mm S.S.304	AL/S.S.	S.S.	SKF make or equivalent	5.00 kg

SPECIFICATIONS OF VENTILATOR FANS ▲▼

They are Vacuum Formed using 100% virgin and U.V. stable PC Solid Plain Sheets. The PC Sheets are also provided with a 30 micron thick U.V. Coating on one or both sides (as required by the customer) to guard against harmful U.V. Rays of Sun. As a result, they do not de-generate rapidly (become yellow and brittle) when exposed to sunlight for long periods of time. They are highly durable and have a service life of more than 10 years.

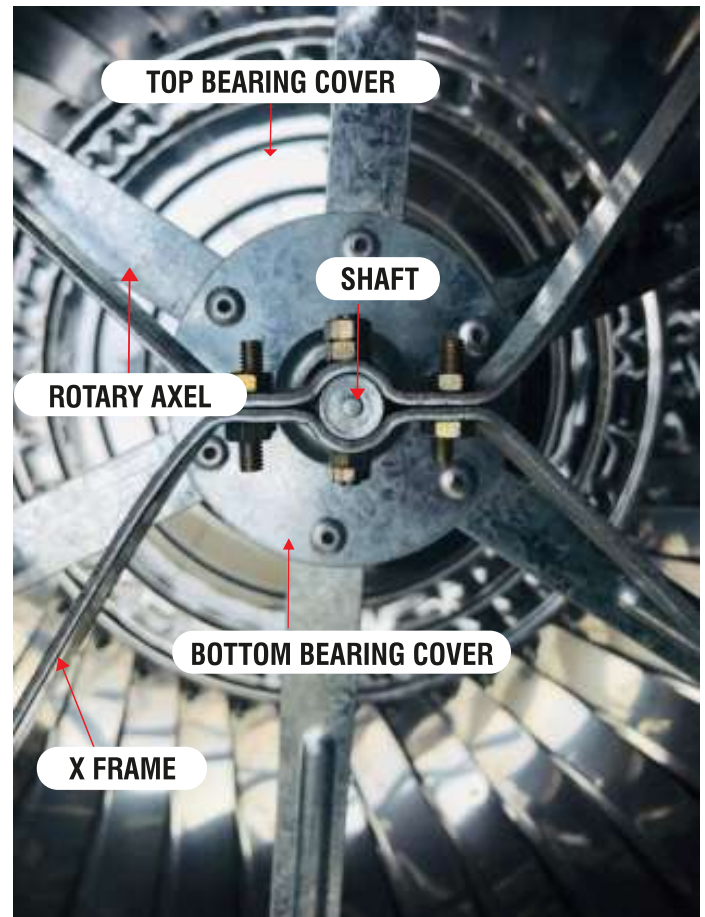

POLYCARBONATE BASE PLATE

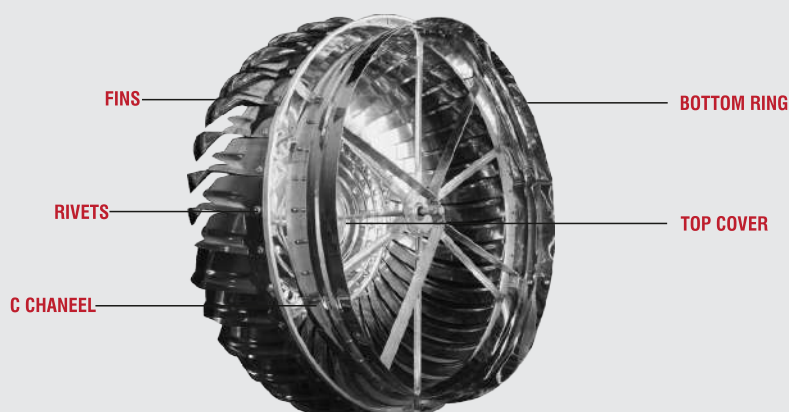
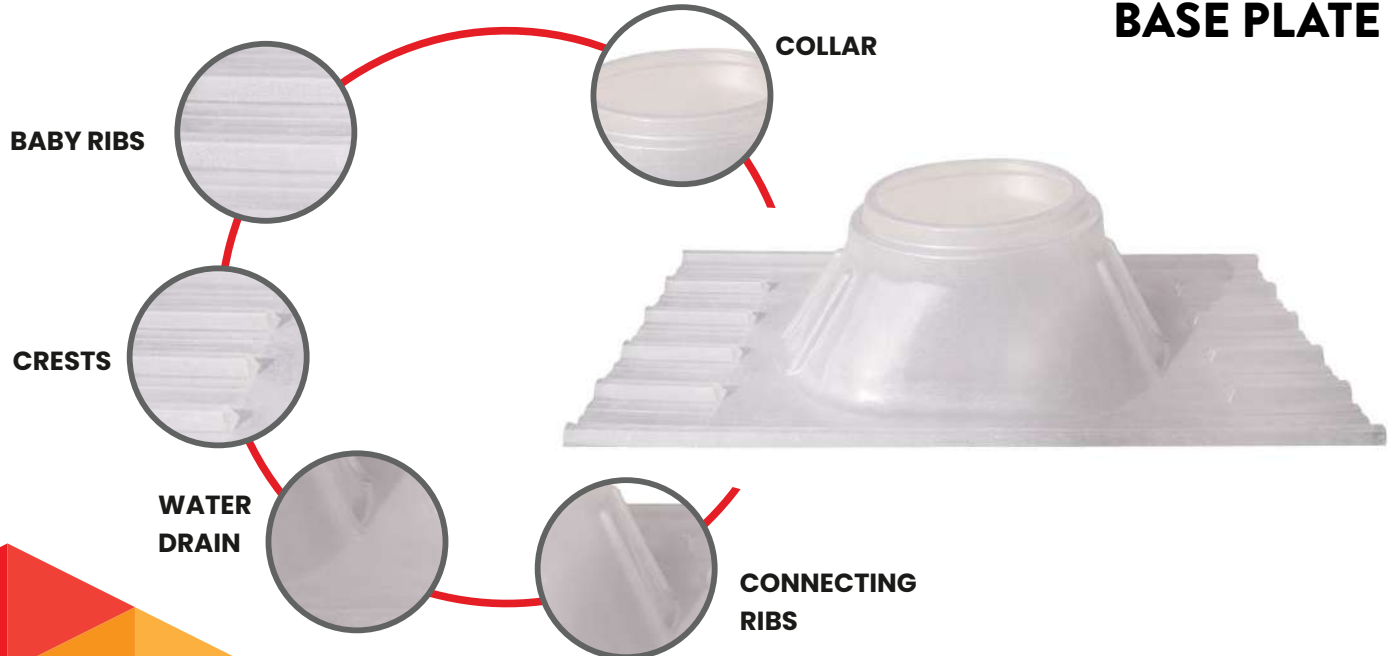

FLASHINGS & ACCESSORIES

FLASHING DIAGRAM			
FT-01 150 JAMB TRIM	FT-02 305 HEAD TRIM	FT-03 495 DRIP TRIM	FT-04 220 R.V. TRIM -1
FT-05 406 CLOSER TRIM	FT-06 305 EAVE TRIM	FT-07 406 RAKE TRIM	
FT-08 406 CORNER TRIM (EXTERNAL)	FT-09 406 CORNER TRIM (INTERNAL)	FT-10 610 RIDGE CAP	
GT01 610 EAVE GUTTER	EC-01 EAVE GUTTER END CAP	FT-11 370 BASE TRIM-1	
DENOTES PAINTED SIDE			

AVAILABLE COLOURS



RAL 9002 OFF WHITE



RAL COLOR 5012 SKY BLUE



BRICK RED



RAL 5005 NOVA BLUE



RAL 6016 ENVIRONMENTAL GREEN



TERRACOTTA



RAL 9007 ALUMINIUM GRAY



BARE NON COLOUR



RAL 2008 ORANGE



RAL 6002 LEAF GREEN



RAL 5019 CAPRI BLUE.



SEECO RED



RAL 6005 CAULFIELD GREEN



RAL 5018 TURQUOISE BLUE



GRAPHITE GREY RAL 7024

Louvers are predominantly utilized in industrial and storage facilities. They play a crucial role in the ventilation system, which is often necessary to mitigate the accumulation of dust, vapor, and heat within the interior spaces of buildings to acceptable levels. When properly positioned in the perimeter walls of a structure and utilized in conjunction with roof ventilators, louvers facilitate continuous circulation of natural air. This integration significantly enhances the indoor environment, promoting a healthier atmosphere for the building's occupants.

S TYPE LOUVERS WITH ALUMINIUM MOSQUITO MESH

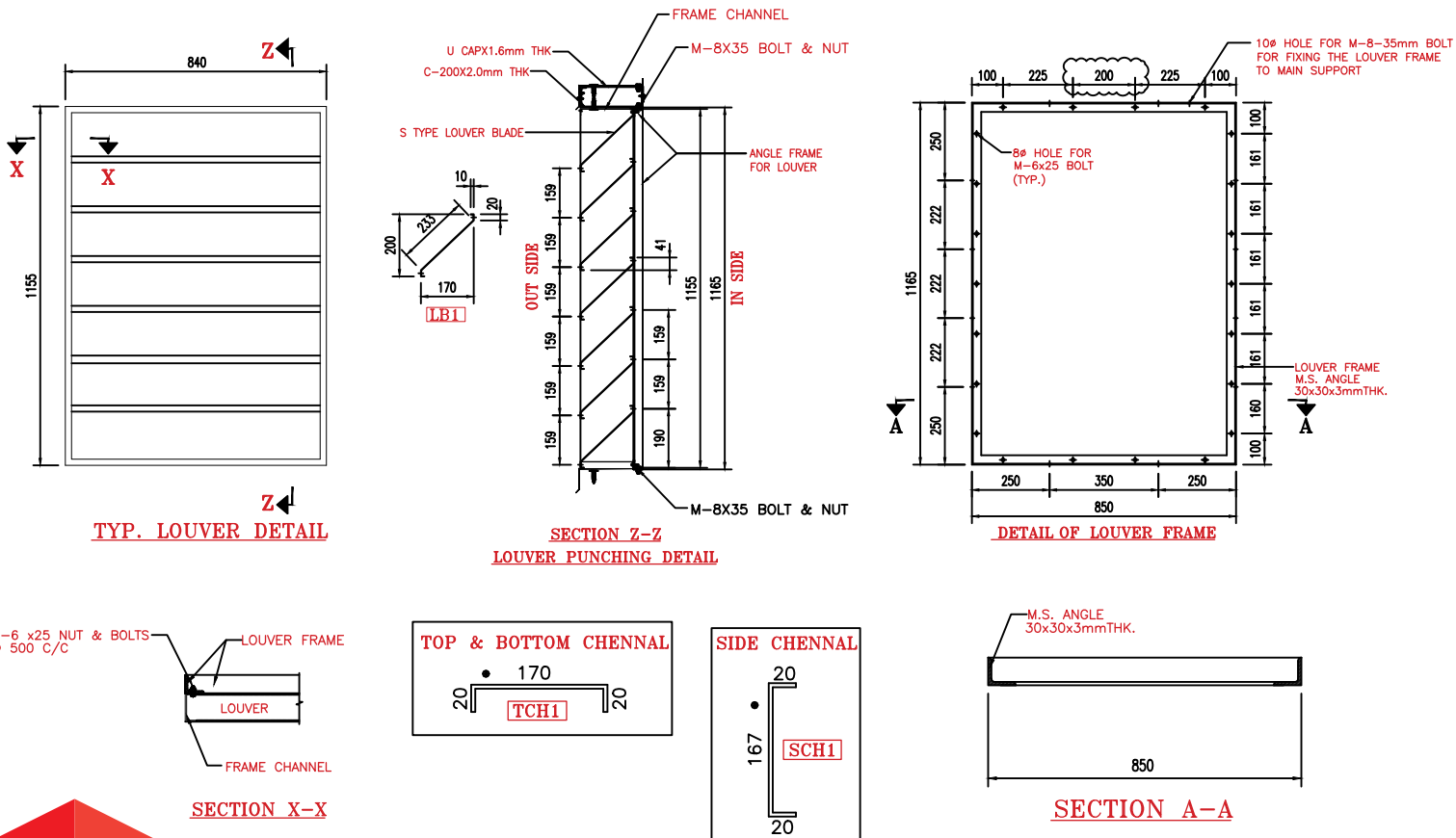

SPECIFICATIONS

THICKNESS (MM): 0.3 TO 1

TYPE: Z PROFILE

STANDARD SIZE:
1 X 1 & 1.5 X 1.5 MTR.

GRADE: 550 MPA

FINISH: PRE PAINTED COATED
STEEL WITH ALL RAL COLOUR / BARE

ACCESSORIES

CURVE & CRIMP

ROOFING SHEETS

Crimp Curved Hi-Rib is developed to provide versatility and creativity. It brings new and refreshing design to commercial, industrial and domestic buildings.

- ▲ Crimp Curved Hi-Rib is available in Galvalume / Galvanized Steel with 245 Mpa, 345 Mpa and 550 Mpa.
- ▲ For Crimp Curved Hi-Rib, the minimum radius of curvature is 550 mm to inside of sheet And minimum length of the sheet either end of a curve is 180 mm at leading end and 200 mm at the lagging end.
- ▲ Arko can manufactured up to 13 mtr single length curve sheet, which we are already supplying for Railways.
- ▲ Crimp Curve Profile Ranges - Full length Curve Profile, End Curve Profile, Ridge Curve Profile, North Light Curve Profile.

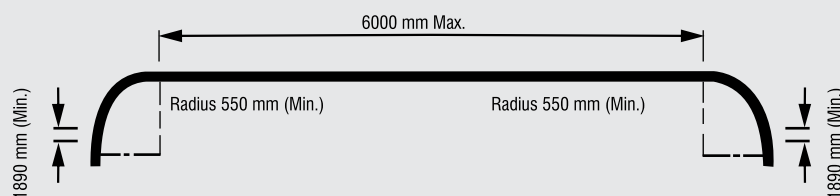
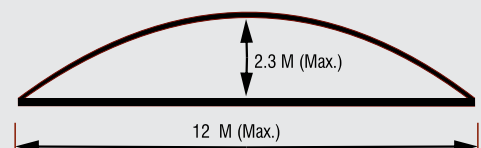
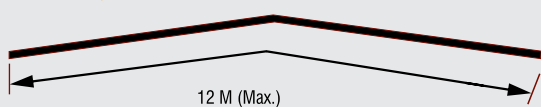
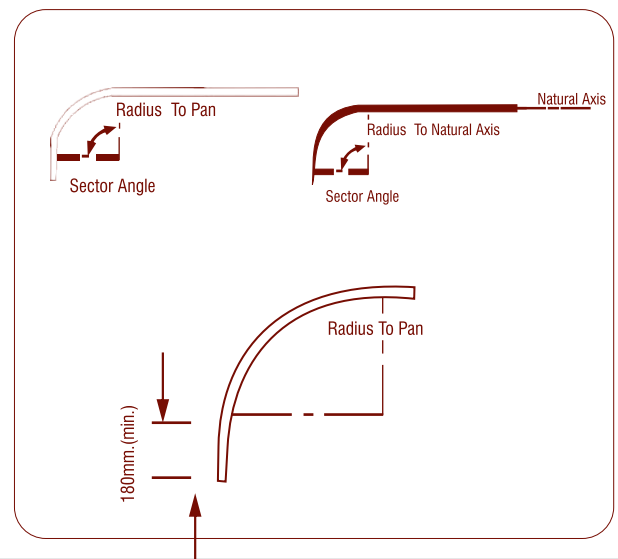
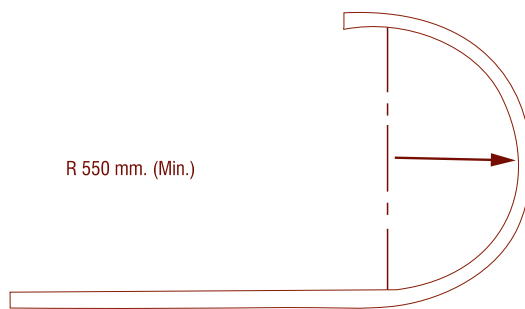

ACCESSORIES

KP SELF DRILLING

SCREWS ▲▼

(MADE IN TAIWAN)



1. Self-drilling screw for fast assembly in one step.
2. Perfect Sealing(PS) feature - specially engineered neered geometry below the head which prevents over-compression of the EPDM washer, helping to reliably seal out water.
3. Fastening sheet metal and profiles to steel substructures and framing, with or without intermediate insulation layers.
4. EPDM rubber washer - creates a more reliable seal against water.

Sizes in mm - #12-14 & #12-24

Length - 19,25,55,68, 75,100,125,150,175



For the best performance in a cyclone, It is important to choose the right wind tie and washer system for crest fixing. KP washer is designed to withstand high wind loads and minimise the stress b/w the washer and the roof sheet.

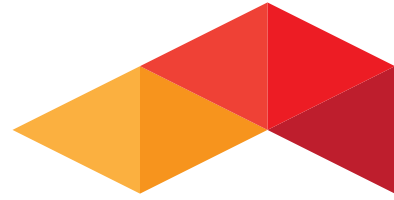

GUN FOR Silicon Sealant

Gun for 300 ml cartridge, Heavy duty high quality applicator gun for use with cartridge products.



MP-301 o, High quality multi-purpose neutral cure silicone sealant.

- Usage: Suitable for use in interior & exterior sealing in masonry rated applications.
- Skinning time: 7 - 15 minutes Curing rate: 2 - 4 hrs/mm • Packing: 280 ml Cartridge (Clear, Black, White, Grey & Metallic)



GP-100, General purpose, most effective one part acetoxysilicone sealant for many applications

- Usage: Suitable for general purpose sealing & bonding applications Skinning time: 4 - 8 minutes.
- Curing rate: 1 - 2 mm/hr
- Packing: 260 ml Cartridge (Clear, black & White)

OUR PROJECTS

NUCLEAR FUEL COMPLEX

HYDERABAD 

Area: 12,000 sqm



SKILL INDIA DEVELOPMENT, NBCC

WITH SAHUSON INTERIORS - ODISHA 

Area: 8,000 sqm



OUR PROJECTS



RAILWAY WAGON SHED

DELHI 

Area: 18,000 sqm



INDIAN OIL (IOCL) JAIPUR, RAJASTHAN

Area: 4,000 sqm

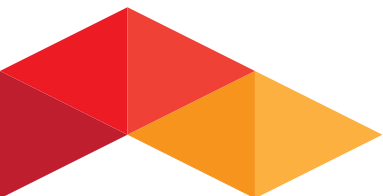

OUR PROJECTS

PM ANNA BHANDAR KOLKATA

Area: 1,500 sqm



ESR

DELHI

Area: 18,000 sqm

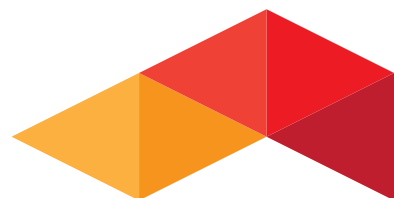

OUR PROJECTS



CAVINCARE

GUWAHATI



Area: 8,000 sqm



SARUSAJAI STADIUM

GUWAHATI



Area: 10,000 sqm

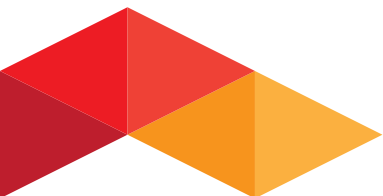

OUR CLIENTS

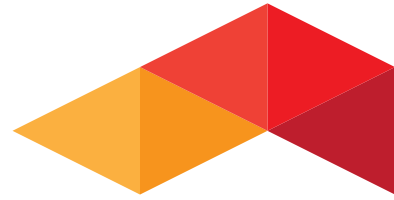

AmbujaNeotia



SILVER SPOONS
Your Perfect Host



Over **1000** Buildings across **100** cities in **20** states

GHAZIABAD

M/S ARKO99 PLASTIC AND STEELS

Plot No. 8A, Khasra No. 1603/2
1st Floor, Opp. Jain Dharm Kanta
Uttar Pradesh, 201009
+91-7987954995
enquiry.arko@gmail.com

GUWAHATI

ARKO BUILDING PRODUCTS

2nd Floor, NCA SQUARE, Gate No. 1
Maligaon, Guwahati - 781011
+91-7099095364
sales.northeast@arkobuildingproducts.com

GWALIOR

BINDAL PLYWOOD

Behind Old Police Chowki
Daulatganj, Lashkar, Gwalior
Madhya Pradesh, 474001
+91-9762725249
enquiry.arko@gmail.com

KOLKATA

M/S BUILDCON

137E, Picnic Garden Road
Ground Floor, Kolkata,
West Bengal, 700039
+91-8240284302
wbsales.arko@gmail.com



ARKO BUILDING PRODUCTS PVT LTD

www.arkobuildingproducts.com